

Roller in Polyamide and with PU tread (Types 20 & 30)



Very high load capacity
High wear resistance
Very low rolling resistance
Floor protecting
Low noise
Maintenance-free under normal operating conditions

Type 20 polyamide rollers and Type 30 with PU tread are high-quality, general-purpose rollers for industrial applications. Type 20 rollers incorporate use of finest quality virgin polyamide raw material to ensure maximum performance and finish of the product throughout its lifetime. Characteristics of this range are a very high load capacity, high wear resistance and maintenance-free under normal conditions.

Type 30 has, in addition to the high quality hub of polyamide, a tread of a 98° Shore A polyurethane which is mechanically and chemically bound to the polyamide. Characteristics of this range are high load capacity and wear resistance but in addition a further smoother and noiseless ride. All wheels are also conditioned prior to delivery to ensure that the products have their full strength from day 1. Both Type 20 and Type 30 rollers are prepared for use with standard ball bearings.

In addition to this range and other standard products offered by Stellana and Elastomeric, we can also offer design and production of custom-made products.



Stellana is a world leader in injection moulding thermoplastic wheels for industrial material handling applications with more than 60 years of experience. Together with Elastomeric, we offer wheel products in materials ranging from rubber to thermoplastics to polyurethanes. We are a global organization with operations in North America, Europe and Asia.

Stellana

A HEXPOL COMPANY

Roller in Polyamide and with PU tread (Type 20 & 30)

Type 20

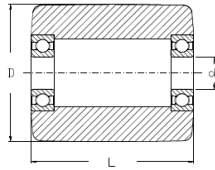

Dimension			Hub for ball bearing		Weight	Art no ¹⁾
Diam.	Length	Hub bore	Load cap.	Diam. x Depth		
D (mm)	L (mm)	D (mm)	(kg)	(mm)		(g)
82	60	20		47 x 14	6204	89 02 00
82	70	20		47 x 14	6204	88 24 00
82	72	20	800	47 x 14	6204	290 74 57 00
82	78	20	900	47 x 14	6204	360 63 24 40
82	90	20		47 x 14	6204	89 39 00
82	92	20	1100	47 x 14	6204	382 74 48 10
82	98	20	1200	47 x 14	6204	367 71 14 30
82	100	20	1200	47 x 14	6204	430 89 41 10
82	105	20		47 x 14	6204	88 13 00
85	75	20	900	47 x 14	6204	345 88 17 00
85	75	17	900	41,6 x -	Special	335 71 21 00
85	90	20	1100	47 x 14	6204	445 90 50 00
85	100	20	1200	47 x 14	6204	460 67 83 00
85	100	17	1200	41,6 x -	Special	460 71 20 00

Type 30

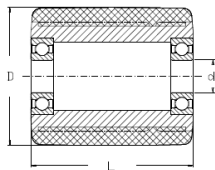

Dimension			Hub for ball bearing		Weight	Art no ¹⁾
Diam.	Length	Hub bore	Load cap.	Diam. x Depth		
D (mm)	L (mm)	D (mm)	(kg)	(mm)		(g)
82	78	20	500	47 x 14	6204	400 73 11 10
82	92	20	600	47 x 14	6204	435 74 50 10
82	98	20	750	47 x 14	6204	490 73 13 20
85	75	20	500	47 x 23	6004	375 70 53 00
85	75	17	500	41,6 x -	Special	375 72 81 10
85	90	20	600	47 x 23	6004	485 71 10 00
85	100	20	750	47 x 23	6004	530 70 73 00
85	100	17	750	41,6 x -	Special	510 72 79 10

1) When ordering complete bearings replace last digit in the article no. with 3, e.g. 89 02 03

DATA AND DIMENSIONS MAY BE CHANGED WITHOUT NOTICE.
 Information in this document may contain inaccuracies or typographical errors. Information may be changed or updated without notice.



A HEXPOL COMPANY

Sweden Tel: +46 584 44 48 00 · info@stellana.se
 Sri Lanka Tel: +94 114 216 621 · marketing@elastomeric.lk
 USA Tel: +1 262 348 5575 · info@stellana.us
 China Tel: +86 532 81731167 · info@stellana-cn.com
 www.stellana.com · www.elastomericwheels.com